



GoodBoy

BARK CONTROL COLLAR GB681V USER GUIDE



★★★
1YEAR
WARRANTY





www.goodboytraining.com



support@goodboytraining.com



youtube.com/c/GoodBoyDogTraining

Hi there!

We wanted to personally thank you for purchasing our Bark Control Collar. We all love our pets, and we created this collar to help you and your dog to have a relaxed and happy life together.

This collar is safe, effective and easy to use. We designed it specifically to help you get the most out of your training. It's super easy to get started - this pamphlet will tell you everything you need to know.

If you have any questions for us, or think there's anything we should know, please get in touch. We're dog lovers too, so if there's anything we can do to help you and your dog we'll want to know!

Thank you and happy training from everyone at GoodBoy!

From all our staff,
Thank you sincerely



Table of Contents

Contact Us.....	1
Thank you note.....	2
We are on YouTube.....	4
How the Vibration Collar Works.....	5
Training your Dog.....	8
How to Put the Collar on your Dog.....	10
Troubleshooting.....	12
Cautionary Note.....	16
Warranty.....	16

We are on YouTube

If you wish to see more info or watch the instructions in video format, check out our YouTube channel. Among other videos you can see these important instructions.

<http://www.youtube.com/c/GoodBoyDogTraining>



How to test this product correctly

How your bark collar works

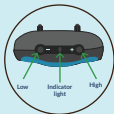

How to correctly set the right sensitivity

How to properly train your dog



How the Vibration Collar Works

This device uses an 8-tiered cycle of corrections to safely train your dog.



We have added four batteries into the box. This should cover the training phase on the vast majority of dogs, giving your own dog plenty of time to unlearn its barking habit. The batteries should last over 200 full cycles, which corresponds to over 1,400 corrections. If the full cycle isn't activated every time by continuous barking, the batteries can last for an even greater number of corrections.

The GB681V Anti-Bark Collar utilizes an eight-tiered correction cycle to train your dog. Each bark within a set time interval solicits a progressively firmer response. These responses are divided between purely sound-based warning tones; warning tones combined with short vibrations; and a sleep mode, which temporarily suspends the collar and resets the correction cycle for your dog's safety.

The first two levels issue audible warning tones only. The first bark results in a short warning tone. If a second bark occurs within 30 seconds, a longer tone sounds. From the third bark onward, both warning tones and short vibrations are delivered.

If your dog continues to bark through the next five levels, escalating combinations of sounds and vibrations are applied until your pet stops barking for 30 seconds – at which point, the Anti Bark Collar will automatically reset. The automatic reset will return the cycle to the first "tone only" level of correction.

To protect your dog, the collar will go into sleep mode and stop working for one minute as the eighth-tier response.

The use of the initial warning tone followed by escalating tones and vibrations sets up a pattern that your dog will learn is caused by its own barking. Bear in mind that it takes time to break bad habits.

When your dog forgets and barks again, the warning tone reminds your pet what will happen if it continues barking without immediately applying a stronger stimulus. At each step, your dog gets to choose whether it's worth the irritation to bark again. We have found that this technique of progressively increasing sound and vibration is a humane and effective method for breaking the barking habit.

The GB681V has adjustable sensitivity settings, which can be set according to the volume of your dog's barking.



Installing/Replacing the Battery

Take off the battery cover and make sure you install the battery correctly.

Install the new battery between the "clip" and "spring" contacts. Note that the "spring" contact is for the negative end and the "clip" contact is for the positive end.

The GB681V has adjustable sensitivity settings, which can be set according to the volume of your dog's barking.

The +/- buttons adjust the sensitivity of the device. Higher sensitivity settings will more easily activate the collar, which may be helpful if your dog's barking does not activate the collar on a low setting. Lower sensitivities require louder stimulus to activate. The sensor has 7 levels. Level 1 has the weakest sensitivity, and level 7 is the most sensitive setting. The default setting is level 4. Please adjust the setting as appropriate to the loudness of your dog's barking.

The indicator light turns on while the collar is administering a warning tone or a shock, and it will blink while the 1-minute sleep mode has suspended the device.

Training your Dog

This version of our Anti-Bark Collars is the best product for training your dog to stop barking while avoiding the use of electric shocks or other painful stimuli. However, the gentler approach of the GB681V Anti-Bark Collar might have lessened effectiveness on old and large dogs that have already developed a long-lasting barking habit. For these dogs, owner-led training from the beginning is important. Some dogs get used to the barking corrections after a few weeks of use and disregard them. This usually occurs due a lack of complementary training from the owner. Without their owners providing guidance, dogs can fail to associate their barking with the Anti Bark Collar's corrections. Following our training guide helps prevent these problems.

If your dog is unable to learn from your training and the corrections from the collar then we suggest our shock collar, the GB681S Anti-Bark Collar. Please contact us with any problems that might arise when using our product, and we will help you any way we can.



I don't notice the collar

1.

Put the collar on the dog so that they can get used to it. Do not turn it on until the dog stops noticing it.

Turn the system on to begin training your dog.

2.



Switch it on



For more information **VISIT OUR YOUTUBE PAGE**

You must say NO loud and clear everytime the dog barks. This will help the dog to make a connection between the impulse and the word NO.

3.



4.

Your dog will soon learn the connection between the impulse and NO; and soon even when you are not around, he will understand the impulse as NO.

Look for a hole in the back of collar



Inserting the battery switches it on (there is no ON/OFF switch):

At the back of the collar there is a small hole. Behind it is an air activation trigger. When the air passes through this hole and hits the trigger then the collar does it's thing. When your dog barks, it causes the air to pass and that's how the collar activates.



For more information **VISIT OUR YOUTUBE PAGE**

How to put the collar on your dog

- 1. MAKE SURE THAT THE BATTERY IS INSERTED CORRECTLY**

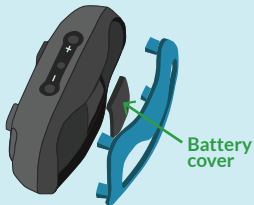

Take off the battery cover and make sure you install the battery correctly*.

* If + and - is mixed up, the collar will buzz continuously.

- 2. IF YOU HAVE A SMALL DOG, THERE WILL BE EXCESS STRAP**



Cut off the extra strap



Heat the end with the lighter

- 3. FOR BETTER COLLAR-NECK CONNECTION**



You may need to shave dog's neck.

- 4. ADJUST THE SENSOR SENSITIVITY**



Use +/- buttons to adjust sensor 7 levels of sensitivity



For more information **VISIT OUR YOUTUBE PAGE**

5. RIGHT WAY TO PUT THE COLLAR

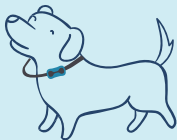

X Tied too loose on the neck

X Placed away from the vocal cord



✓ Ensure that no more than one finger can pass through

Never connect a lead to your GoodBoy collar



For more information **VISIT OUR YOUTUBE PAGE**

Troubleshooting

Does the collar come with batteries?

It comes with four 6V 4LR44 Alkaline batteries. We also sell the batteries on Amazon in case extra batteries are needed. Sometimes, Amazon customers send a product back and misstate the condition of their return, claiming that it is in perfect condition and usable despite missing parts – such as batteries. Amazon then adds the product back into inventory to be sold again. Unfortunately, they don't allow us to check whether everything is still there when one of our collars is returned, which may result in missing batteries.

I need a new battery but don't know which to buy.

The battery type used by the collar is 4LR44 6V Alkaline. This battery also goes under other common names like PX28A, A544, K28A, and V34PX. You can find these batteries on Amazon, including the 4LR44 6V Alkaline batteries we sell. We recommend you select the battery with the best reviews.

How do I put the battery in?

Refer to the graphic on page 4. You need to remove the decorative cover. Beneath this is the battery cover. Remove the battery cover and insert the battery. Make sure that the +/- ends of the battery are positioned correctly. Otherwise, the device may malfunction.

Is there a battery indicator?

No; however, the device signals when a battery is inserted and when an inserted battery has a low charge level. When inserting a battery, the device beeps once. When an inserted battery has reached a low charge level, the device starts to buzz.

I changed the battery, and it immediately started buzzing continuously.

The +/- ends of the battery are mispositioned. Reinsert the battery with the ends flipped the other way around.

How long should the battery last?

One battery should last over 130 full cycles. That means over 900 barking corrections. Higher level corrections use much more energy than lower levels, which makes the lower settings useful for extending battery life and increasing the number of correction cycles. Additionally, if your dog is a quick learner and stops after a few barks, the device often will work for even longer. If that's not the case, the battery was already partly depleted or otherwise defective, [contact us at support@goodboytraining.com](mailto:support@goodboytraining.com) if you have persistent battery problems.

Is the collar waterproof?

It is not waterproof, but light rain shouldn't cause any problems if the strap and cover are correctly positioned over the battery compartment.

Does the collar produce an ultrasonic beep like a dog whistle?

No, the collar's sound warnings are audible to humans.

Are there any breeds that this collar is not recommended for?

There are no restrictions on which breeds the collar is best suited for except for the length of the strap, which is 21 inches. The collar may be difficult to fit on especially large or especially small dogs. Also, larger and older dogs might not react to the sound and vibration as hoped without proper training.

What is the recommended dog weight for this product?

The lowest recommended weight is 8 lbs. The collar's anti-barking corrections will still work without hurting a smaller dog, but the size of the collar (21 inches) may simply be too large. There is no upper limit on weight, but if a dog's neck is too large, the collar won't fit. The maximum strap length is 21 inches.

Is there a maximum time that the collar can be continuously worn?

Collar should be taken off periodically (after 10-12 h) to avoid pressure necrosis due to the probes touching the skin constantly.

What are the black prongs for?

We have included two sets of interchangeable prongs, which are for penetrating dog hair to provide good collar to neck contact. This allows the sensor to pick up barking so that the collar can work properly. The two sets of prongs are of different lengths, which allows you to pick the length best suited for your dog.

How loud are the beep and the vibrations?

Visit our YouTube page to see how to test the device and evaluate the volume of the audio warnings and vibrations.

Can the collar punish your dog if another dog barks?

If another dog is close and barks loudly enough, then yes. Sensor sensitivity adjustments might help reduce false corrections. Also, a tightly fitting collar can reduce these occurrences. If you own the other dog that is causing the problem, consider buying another Bark Control Collar.

I have a large and old dog that doesn't respond to the collar.

There are several possibilities and fixes for this problem. Larger dogs might not feel the vibrations as much as smaller ones. This might be due to thick hair, for which we have provided two sets of interchangeable prongs. The two sets of prongs are of different lengths, which allows you to pick the length best suited for your dog. If swapping the prongs does not improve reactivity, you might consider thinning or shaving off thick hair under the collar so the prongs make better contact to your dog's skin. Older dogs might have poorer hearing and cannot react to the beeps. Also, older dogs might be just so set on their habit that the collar's correction alone is not enough, and you will need to assist with the training.

Can I use the collar without prior instruction as provided in this pamphlet and in your YouTube videos?

You can, but it's not recommended, especially with bigger and older dogs who are less sensitive. This vibration collar is the best tool for training your dog without having to use static shock. However, without complementary, owner-led training the success of the collar is not 100% guaranteed. Very

rarely, even with the proper training, the training process may take unusually long. Please contact us at support@goodboytraining.com if you encounter this problem, and we will figure out the best way to help you.

Why doesn't the collar activate when it's supposed to?

There are several possibilities: The collar may be too loosely tied; only one finger should fit under the belt. The electrodes may not be positioned on the vocal chord; shaving or trimming might be necessary for better collar-to-neck connection. The battery may be empty.

What are the +/- buttons for?

They adjust the sensor's sensitivity to barking. If you push the - button until the beeping stops, the device will be set to the 1st level – the weakest sensitivity level. On level 1, the collar doesn't activate as easily. If you push the + button until the beeping stops, the device will be set to level 7, the highest sensitivity level.

How do I know what level to adjust the sensitivity settings to?

Answering this question requires your testing and judgment to find the setting suitable for your environment. It is set on level 4 by default.

Cautionary Notes

1. Do not allow your dog to chew on this collar. You should also attempt to minimize scratching or clawing at the casing.
2. This device is made of plastic and electronic components that are not digestible. Consult your local vet if your dog swallows any part of this product.
3. The collar is not intended for use as a restraining collar. If you are using a leash, do not attach it to the bark collar. Instead, use the leash with a separate restraint collar.
4. Although the Anti-Bark Collar microprocessor is designed to differentiate your dog's individual bark from stray environmental noises, the unit may occasionally be activated by other vibrations or sounds. This is normal, but it should not happen so often as to be confusing to your pet. If the unit is falsely triggered by excessive scratching, shaking of the head, or rolling on the ground, your pet may be suffering from fleas or ear mites. If these activities are evident, have your pet checked by a veterinarian for parasites.

Warranty

If you purchased this from Amazon, you can get a refund/replacement with presenting your order number

